

FRIGIDAIRE

Factory Parts Catalog

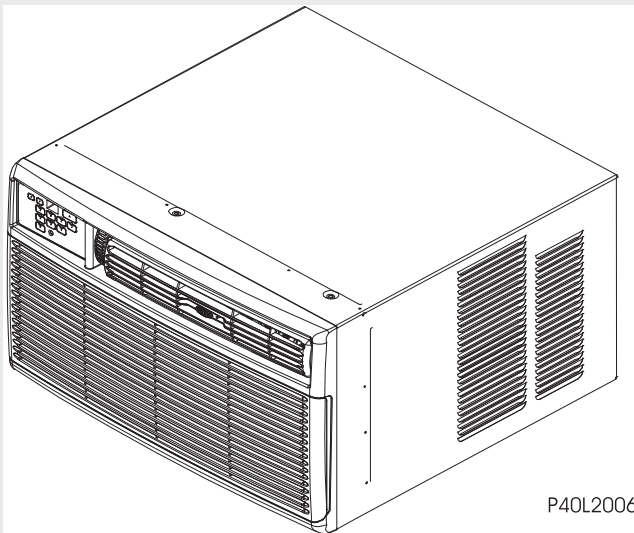

P40L2006

Product No.	LRA087AT70	LRA087AT71	LRA087AT72	LRA087AT73
Series	MSII	MSII	MSII	MSII
Color	white	white	white	white
Volts	120	120	120	120
BTU-Cooling	8,000 btu	8,000 btu	8,000 btu	8,000 btu
Owner's Guide	2020211A1113en	2020211A1113en	2020211A1113en	2020211A1113en
Installation Instructions	2020213A0462en	2020213A0462en	2020213A0462en	2020213A0462en
Market	North America	North America	North America	North America

Frigidaire

P.O. BOX 212378
AUGUSTA, GA 30917

ROOM AIR CONDITIONER

Model No.
LRA087AT7

Publication No.
5995562435
10/03/26
(EN/SERVICE/WTC)
099

RECOMMENDED SPARE PARTS

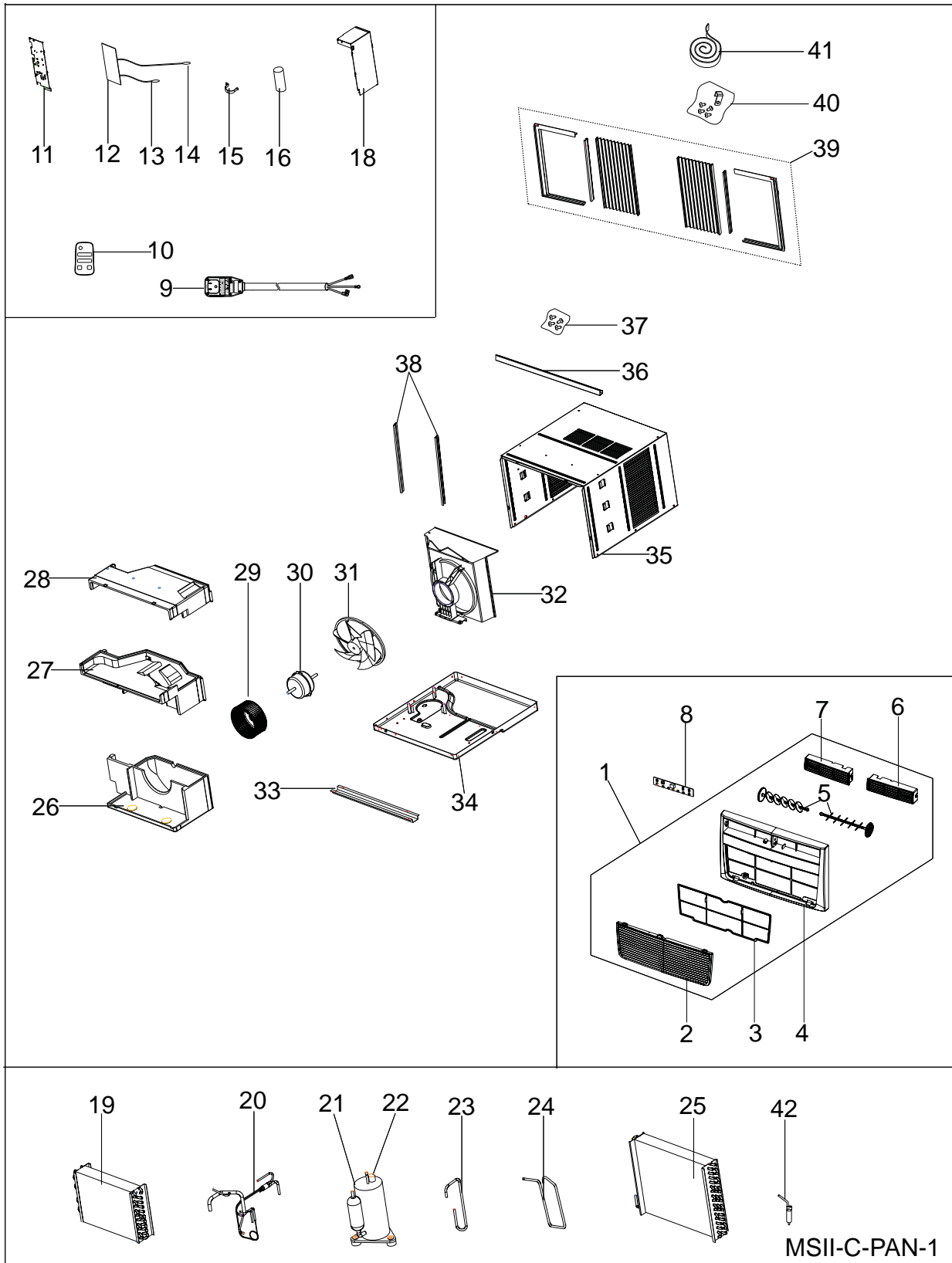

MSII-C-PAN-1

RECOMMENDED SPARE PARTS

Model Index: A LRA087AT7 (LRA087AT70)
 B LRA087AT7 (LRA087AT71)
 C LRA087AT7 (LRA087AT72)
 D LRA087AT7 (LRA087AT73)

POS. NO	PART NO.		DESCRIPTION
1	5304477069	A B C D	Front Assembly, complete panel
2	5304477070	A B C D	Panel, front grille, tilt-out
3	5304477071	A B C D	Filter, air, plastic frame
4	5304477072	A B C D	Frame, front assembly
5	5304477073	A B C D	Louver, vertical
6	5304477074	A B C D	Louver, horizontal, right
7	5304477075	A B C D	Louver, horizontal, left
8 #	5304476177	A B C D	PC Board, display/input
9 #	5304476525	A B C D	Power Cord, electric, LCDI
10 #	5304476866	A B C D	Remote Control, transmitter
11	5304477053	A B C D	Cover, electrical box
12 #	5304476183	A B C D	PC Board, main, control/power
13 #	5304471275	A B C D	Thermistor, evap sensor, defrost
14 #	5304476053	A B C D	Thermistor, temp sensor, indoor
15	5304471203	A B C D	Strap, capacitor clamp
16 #	5304471306	A B - -	Capacitor
16 #	5304476003	- - C D	Capacitor
18	5304476551	A B C D	Control Box
19 #	5304476568	A B - -	Evaporator, with cap tube
19 #	5304476577	- - C D	Evaporator, with cap tube
20 #	5304476569	A B - -	Tube, capillary
20 #	5304476578	- - C D	Tube, capillary
21 #	5304476006	A B - -	Compressor, with overload
21 #	5304476002	- - C D	Compressor, with overload
22 #	5304476291	A B - -	Overload Protector, compressor
22 #	5304476292	- - C D	Overload Protector, compressor
23 #	5304476570	A B - -	Tube, suction
23		C D	Tube, suction – none in this model
24 #	5304476571	A B - -	Tube, discharge
24 #	5304476579	- - C D	Tube, discharge
25 #	5304476572	A B - -	Condenser
25 #	5304476580	- - C D	Condenser
26	5304476557	A B C D	Scroll, blower housing, bottom
27	5304476573	A B C D	Scroll, blower housing, middle
28	5304476559	A B C D	Scroll, blower housing, top
29 #	5304476051	A B C D	Blower Wheel, centrifugal
30 #	5304476115	A B C D	Motor, fan
31	5304476052	A B C D	Fan Blade, axial
32	5304476560	A B C D	Shroud, condenser/fan
33	5304476521	A B C D	Rail, shutter track, bottom
34	5304476576	A B - -	Base, unit chassis
34	5304476561	- - C D	Base, unit chassis
35	5304476562	A B C D	Cabinet, wrapper/sleeve
36	5304477054	A B C D	Rail, shutter track, top
37	5304472191	A B C D	Screw Kit, top rail mount
38	5304476523	A B C D	Retainer, shutter, cabinet sides
39	5304476524	A B C D	Window Filler Kit, slider panels, accordion
40	5304472192	A B C D	Hardware, mounting, screws/locks
41	5304472211	A B C D	Seal Kit, foam, sash filler
42 #	5304476201	A B C D	Drier-filter

WIRING DIAGRAM

OPP/MSII/COMI/COMII Electronic without Ionizer ---

202021190003

